

Tools needed:

- 1.5mm hex wrench
- 2.0mm hex wrench
- 2.5mm hex wrench
- 7mm hex wrench

Important notes:

- This kit fits models Slash 4X4 and Stampede 4X4
- Additional parts required, see below

Front driveshaft removal:

1. Remove the wheel nut from the axle, and slide the wheel and tire off of the axle.
2. Slide the hex adapter off of the axle, and then push the axle pin out of the axle.

Tip: Use a small flat-tip screwdriver to remove the adapter from the axle pin.

3. Using a 1.5mm hex wrench, remove the screw pin from the differential output yoke and slide the output yoke and driveshaft off of the differential output shaft (A).
4. Using a 2.5 and a 2.0 hex wrench, remove the front steering blocks (A).

Rear driveshaft removal:

1. Remove the wheel nut from the axle, and slide the wheel and tire off of the axle.
2. Slide the hex adapter off of the axle, and then push the axle pin out of the axle. **Tip:** Use a small flat-tip screwdriver to remove the adapter from the axle pin.
3. Using a 1.5mm hex wrench, remove the screw pin from the differential output yoke and slide the output yoke and driveshaft off of the differential output shaft (B).
4. Using a 2.5 and a 2.0 hex wrench, remove the rear axle carrier (B).

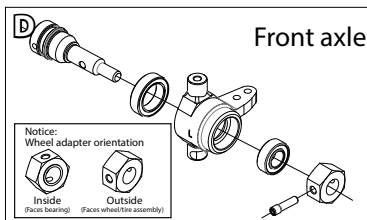
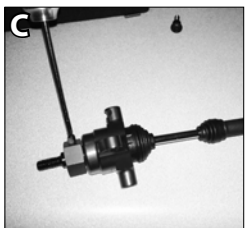
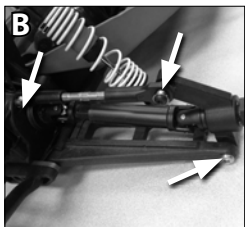
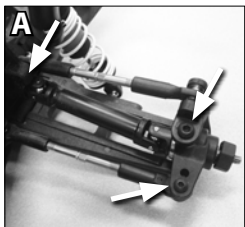

Install metal driveshafts (Front):

1. Install the 10x15 bearing that was previously used in the steering block and 6x12 bearings from part #5117 into the front aluminum steering blocks (#6439).
2. Insert the stub axle on the CV driveshaft into the ball bearings.
3. Assemble the wheel adapter to the stub axle with the included 3x11 screw pin (C). (Note orientation of wheel adapter (D).
4. Reinstall front axle (E).

Install metal driveshafts (Rear):

1. Install the 6x12 bearings from #5117 into the rear aluminum axle carrier (#6455).
2. Install the included 6x8x0.3 PTFE coated washer onto the stub axle (F).
3. Insert the stub axle on the CV driveshaft into the ball bearings installed in the axle carrier.
4. Assemble the wheel adapter to the stub axle with the included 3x11 screw pin (G).
5. Reinstall rear axle (H).

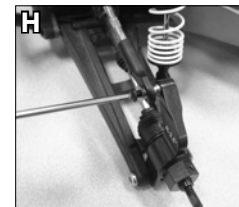
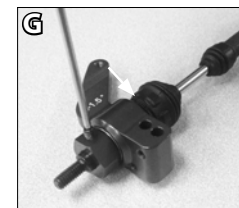
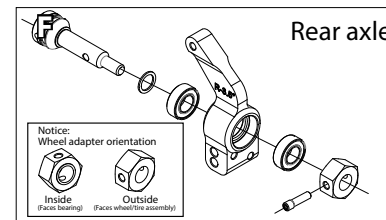

NOTICE

Wheel modifications:



1. The supplied drill bit is used to increase the hole diameter in your wheels.
2. A drill press or drill driver is highly recommended. Care should be taken to use safe practices when using power tools.

Additional parts needed:

6451	Driveshaft, front (steel-spline constant-velocity)(complete assembly)(1).....	\$38.00
6452	Driveshaft, rear (steel-spline constant-velocity)(complete assembly)(1).....	\$38.00
6439	Steering blocks, 6061-T6 aluminum, left & right (blue-anodized)(1).....	\$30.00
6455	Axle carriers, rear, 6061-T6 aluminum, left & right (blue-anodized)(1).....	\$35.00
5117	Ball bearings, blue rubber sealed (6x12x4mm)(2) - (3 needed)	\$4.00